





Strategically  
*Located*

5 Min to Al Maktoum International Airport

20 Min to Dubai Hills Estate / Dubai Hills Mall

28 Min to Dubai Marina and Dubai Marina Mall

35 Min to Downtown Dubai and Dubai Mall



**GP**  
GRAND POLO  
CLUB & RESORT

DUBAI METRO LINES  
RED LINE  
GREEN LINE  
FUTURE BLUE LINE



# An Unprecedented *Vision*

A manifestation of luxurious living, blending the heritage of captivating equestrian experiences with seamless landscapes exuding modernity. A lifestyle that offers an opportunity to be one with nature, every day.







# Grand Polo

## *Club & Resort*

Masterplan Total Area	5.54 million SqM
Total Open Space	1.59 million SqM
Total Polo Field & Stables Expanse	340,000 SqM
Clubhouse GFA	5,600 SqM
Total Mix Use GFA	1.56 million SqM
Total Residential Clusters	22
Total Residences	6,661
Estimated Resident Population	26,965





*A Balanced Masterpiece*







## *Equestrian* Opulence

Grand Polo Club & Resort is a masterplan which is built to strike fine balance between lifestyle principles of leisure, nature, connectivity, wellness and recreation.







# Experience The *Exceptional*

Featuring three polo fields, three jumping arenas, paddocks, a vareo track, elegantly curated horse stables, viewing decks and a social tack lounge – this remarkable destination is designed to have all the elements strategically placed to enhance the experience of both equestrians and spectators.

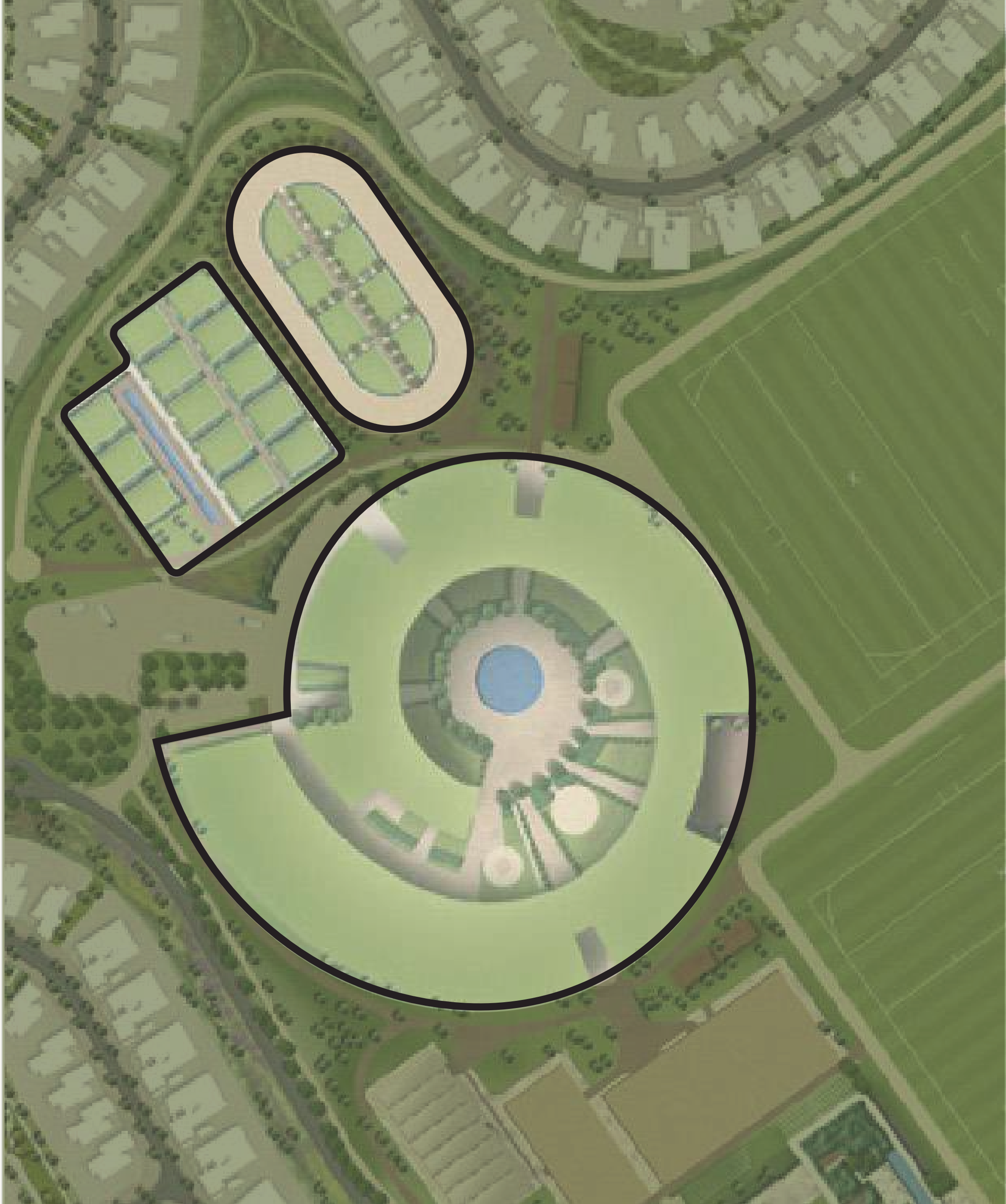

- The Stables
- The Members Lounge
- Vareo Track & Jumping Arenas
- Riding School







# Thematic Play of *Form & Function*

The landscape defining moves and themes are at the forefront of unifying the vision of the Grand Polo Stables.

Purposeful integration of circular elements have been done to emphasize on expansiveness and to frame important landscape moments. Water feature is incorporated to serve a playful scenery.









# The *Entryway*

Following the design for the masterplan and echoing the undulating landscapes of the open space the Entryway moment is crafted to assure continuity of visual appeal throughout the resident's journey home.

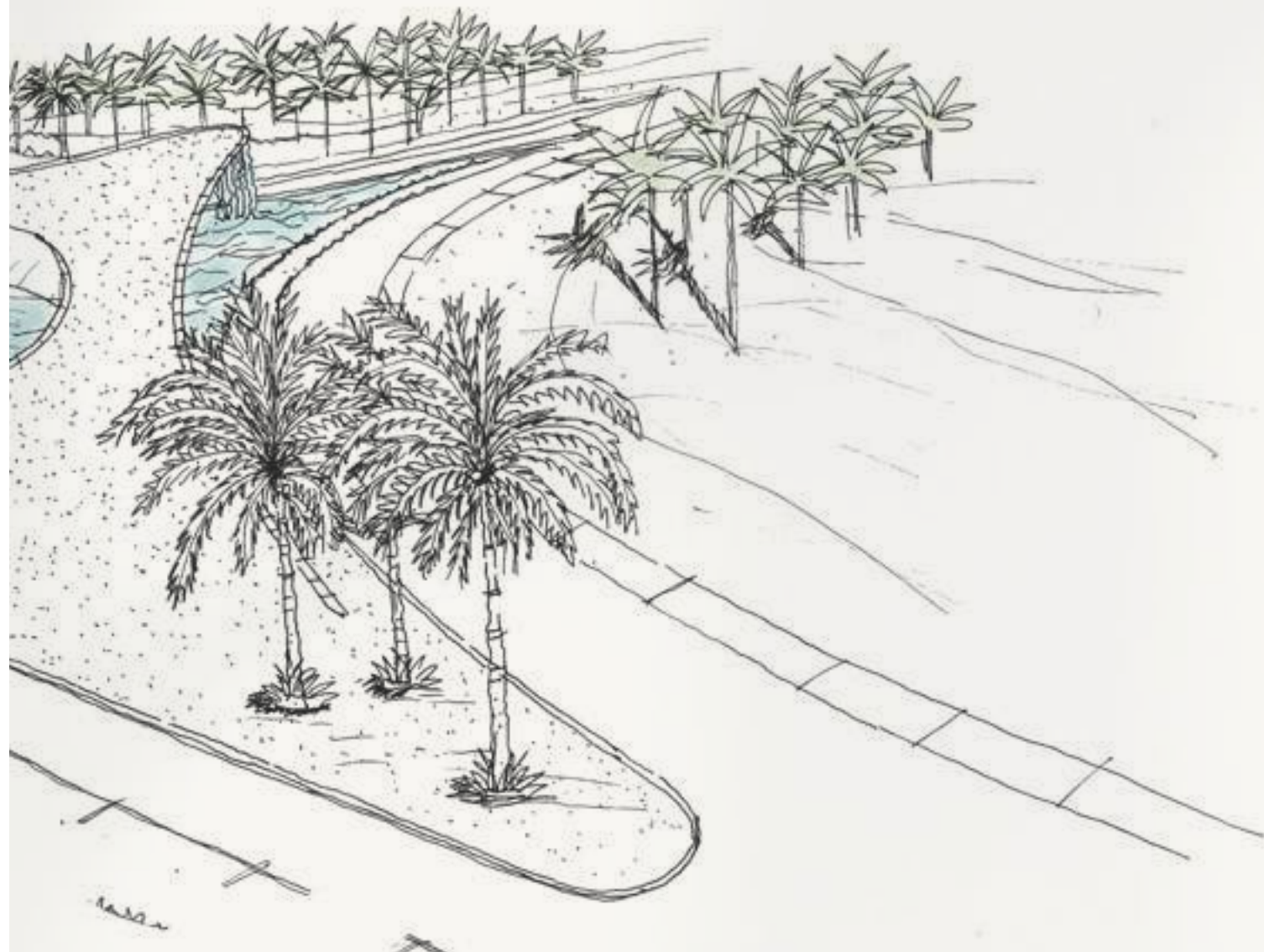







Introducing the *First Phase*





# Life Beyond *Ordinary*

- |    |                        |    |                        |
|----|------------------------|----|------------------------|
| 01 | Grand Polo Club Estate | 13 | Fitness Area           |
| 02 | Community Centers      | 14 | Dog Park               |
| 03 | Galloping Fountain     | 15 | Forest Walk            |
| 04 | Art Pavilion           | 16 | Picnic Area            |
| 05 | Open Lawn              | 17 | Floral Garden          |
| 06 | Football Courts        | 18 | Mounded Garden         |
| 07 | Muga Court             | 19 | Resting Areas          |
| 08 | Baseketball Half Court | 20 | Playground             |
| 09 | Padel Courts           | 21 | Pump Track             |
| 10 | Volleyball Sand Court  | 22 | Mosque                 |
| 11 | Mini Golf              | 23 | Entrance & Guard House |
| 12 | Bounce Playground      | 24 | Toilet Blocks          |

